



Professional wireless communication system solution supplier

# Product Catalog



**Kirisun Communication Co.,Ltd.**

**Headquarters**  
ADD: 3rd Floor, Building A, Tongfang Information Harbour,  
No.11 Langshan Road, Nanshan District, Shenzhen 518057, P.R.China  
Tel: +86-755-86106898  
Email: [marketing.os@szkirisun.com](mailto:marketing.os@szkirisun.com)  
<https://www.kirisun.com/en>

FC CE ISO9001

**Kirisun NZ Limited**  
ADD:9 Knight Place Riccarton Christchurch 8041  
New Zealand  
Phone : 0800 454756  
Email : [Sales@kirisun.nz](mailto:Sales@kirisun.nz)  
<https://www.kirisun.nz>

# Product Catalog

03

## DMR Products

DP405	DM588
DP485/DP480	DP770 DP990/DP995
DP580/DP585	TM840
V8	DR700 DR600 TR850

15

## System Solutions

DS1000 DS5500 DS6000

20

## PoC Solution

PoC Solution Network PoC Dispatching Console  
W60/W65 T60/T65  
M50 3G M50 4G  
PoC App TM840-GW

29

## Body Worn Cameras

DSJ-H9s DSJ-F9s DSJ-M9  
DSJ-K9 Docking Station

35

## Kirisun KiNet Intelligent Network System

Kirisun KiNet Intelligent Network System



# Company Profile



Initially established in 1986, Kirisun Communication Co., Ltd is a fully independent company operating its own sales, R& D and manufacturing divisions.



▲ Office environment

Ranked among the leading industry brands, Kirisun brings exacting standards of innovation, quality and excellence to its professional radio terminals and system solutions, providing integrated communications solutions for carrier and private networks.



▲ Production Base in Fujian

Our manufacturing facility is 100% owned and occupied around 20,000 square meters in QuanZhou , operating internationally recognised TUV ISO9001: 2015 quality criteria. The maximum production capacity is nearly 1.2 million per year, together with rigorous and uncompromising quality controls, Kirisun has won the leading Outstanding Enterprise award from local government.

Kirisun invests about 15% of its revenues each year in R&D to promote innovation of technology and products. It has established R&D centers in Shenzhen, Beijing, Guangzhou, Quanzhou in China, as well as in the United Kingdom to support innovation and development of the company. Kirisun has a well-established distribution network covering all over China and more than 80 countries in global market.





# DMR Products



Kirisun DMR products, complying with ETSI open standard, offering a wide selection of DMR radios and solutions, including kinds of portable radios, mobile radios, repeaters and multile sites IP connection solution, dispatching system and DMR Tier3 trunking system to meet different users' needs.

## DP405 DMR Portable Radio

The DP405 portable digital two-way radio complies with standard DMR protocols, supports Tier 1 and Tier 2 modes, and is compatible with other DMR terminals. Capable of operating in both digital and analog modes, it achieves smooth analog-to-digital migration. It satisfies various requirements of industrial applications with richer functions and high cost efficiency.

- Features :
- Campact Size with Clear and Loud Voice
  - Analog&Digital and Mixed mode for smooth migration
  - High-capacity battery for longer work time
  - Improved call capacity with DMO dual-slot communication
  - User-defined voice announcement

- Functions :
- TDMA dual-slot technology doubles call capacity
  - Support individual call, group call, all call
  - Support radio check, kill, stun and unstun and remote monitor
  - 40-bit ARC4 encryption eliminates eavesdropping
  - Support normal and secret alarm, and combination of different alarm types and modes
  - Support pseudo trunking
  - Support Man Down(Optional)



Frequency Band	136~174MHz,350~400MHz, 400~470MHz, 400-520MHz
Channel Capacity	256
Zone Capacity	16
Channel Spacing	25kHz/12.5kHz(Analog) ;12.5kHz(Digital)
Battery	2000mAh Li-ion(Standard)
Battery Life	Analog:15 hours@2000mAh
(5-5-90 Duty Cycle, High TX Power)	Digital: 18 hours @2000mAh
RF Power Output	5W/1W(VHF); 4W/1W(UHF)
Frequency Stability	±1.5 ppm
Dimensions(H·W·D)	34.5mm*60mm*130mm
(with standard battery, without antenna)	
Weight(with standard battery)	280g(2000mAh)
Digital Vocoder Type	ABME+2™
Digital Protocol	ETSI-TS102 361-1,-2,-3

# DP480/485

## DMR Portable Radio

A DMR based professional digital radio, the DP480/485 operates in digital and analog modes and is compatible with conventional analog two-way radios and most digital communication systems. The product features clear voice, high power, rich functions. Together with Kirisun IP multi-site connect system, it forms digital communication solutions that achieve voice dispatcher, voice recording, GPS based positioning, record query and remote control. With richer functions and higher cost efficiency, it meets various requirements of industrial application.

- Features:
- Improved call capacity with DMO dual-slot communication
  - Digital noise reduction for clearer voice
  - Analog&digital and mixed mode for smooth migration
  - GPS Real time location (optional)
  - Support man down (Optional)

- Functions:
- TDMA dual-slot technology doubles call capacity
  - Support individual call, group call and all call
  - Support radio check, kill, stun and unstun and remote monitor
  - 40-bit ARC4 encryption eliminates eavesdropping
  - Support normal and secret alarm, and combination of different alarm types and modes
  - Support pseudo trunking
  - Support Man Down(Optional)
  - High-precision GPS positioning module for instant tracking



Frequency Range	136~174MHz, 400~470MHz
Channel Capacity	256
Zone Capacity	16
Channel Spacing	25KHz/12.5kHz(Analog), 12.5kHz(digital)
Battery	2000mAh Li-ion(Standard)
Battery Life (5-5-90 Duty Cycle, High TX Power)	Analog:15 hours@2000mAh,Digital: 18 hours @2000mAh
RF Power Output	5W/1W(VHF) 4W/1W(UHF)
Frequency Stability	±1.5 ppm
Dimensions(H·W·D)	DP480:35mm*61mm*132mm
(with standard battery, without antenna)	DP485:36.5mm*61.5mm*132mm
Weight(with standard battery)	DP480:305g, DP485:300g
Digital Vocoder Type	ABME+2™
Digital Protocol	ETSI-TS102 361-1,-2,-3

# DP580/585

## DMR Portable Radio

With richer features, reliable design and excellent coverage performance, DP58 series radios are ideal for manufacturing, warehouse and hospitality environments.

- Features:
- Compact & Lightweight
  - IP66 Water Proof
  - Secure Communication
  - Advanced Analog Signaling
  - TDMA dual-slot technology doubles call capacity

- Functions:
- Built-in high-precision GPS positioning module, work with dispatching system to achieve instant tracking and positioning
  - Supports roaming and pseudo trunking
  - Support digital, analog, and mixed mode
  - 3 Programmable keys
  - Support multi-mode emergency alarms and remote control
  - Support 5Tone, DTMF, MDC and 2Tone
  - Support ARC4 40 bits encryption
  - Support AES and DES Encryption (Optional)
  - Support various digital signalings



Frequency Bands	136~174MHz, 400~470MHz
Channel Capacity	256
Zone Capacity	16
Channel Spacing	25kHz/12.5kHz(Analog) 12.5kHz(Digital)
Battery	2000mAh Li-ion(Standard)
Battery Life	Analog:15 hours@2000mAh
(5-5-90 Duty Cycle, High TX Power)	Digital: 17 hours @2000mAh
RF Power Output	5W/1W(VHF) 4W/1W(UHF)
Frequency Stability	±0.5 ppm
Dimensions(H·W·D)	DP585:36.5mm*62.5mm*132mm
(with standard battery, without antenna)	DP580:36.5mm*62.5mm*132mm
Weight(with standard battery)	DP580:316g, DP585:300g
Digital Vocoder Type	ABME+2™
Digital Protocol	ETSI-TS102 361-1,-2,-3



# V8

DMR Portable Radio

The V8 is a professional digital two-way radio elaborately designed with a streamline appearance and an aluminum shell. It supports digital and analog modes and mixed mode, achieving smooth analog-to-digital migration. Cost effective with richer functions, it meets various application needs in such industries as railways, estate management, transport and security service.

- Features:
- OLED screen
  - DMO dual-slot
  - Pseudo trunking
  - GPS positioning (optional)
  - Registration, roaming and Man Down (optional)

- Functions:
- Streamline appearance and OLED screen
  - DMO dual-slot capable of more groups
  - Support registration, roaming, GPS positioning, Man-Down alarm and pseudo trunking
  - Support digital, analog and mixed mode
  - Support radio check, kill (decoding), stun (decoding), activation (decoding), monitoring (decoding) and Lone Worker
  - Audio encryption and color-code based authentication
  - Support multi-mode linkage alarm and Man-Down alarm
  - Battery level announcement
  - Support 200~400 hours of voice recording (custom)



Frequency Range	400~470MHz
Channel Capacity	256
Zone Capacity	16
Channel Spacing	25kHz/20kHz/12.5kHz(Analog) 12.5kHz(Digital)
Battery	2000mAH Li-ion(Standard)
Battery Life	Analog:17 hours@2000mAh
(5-5-90 Duty Cycle, High TX Power)	Digital:20 hours @2000mAh
LCD	OLED,1.1",128*32 pixels
RF Power Output	4W/1W
Frequency Stability	±1.5 ppm
Dimensions(H·W·D)	35.5mm*63mm*140mm
(with standard battery, without antenna)	
Weight(with standard battery)	332g(2000mAh)
Digital Vocoder Type	ABME + 2™
Digital Protocol	ETSI-TS102 361-1,-2,-3



# DM588

Digital Mobile Radio

Compliant to DMR standards, the DM588 digital mobile radio adopts the TDMA dual-slot technology and supports digital and analog modes. The radio features clear voice, high spectrum efficiency and anti-interference as well as rich voice and data services, bringing you extraordinary new experience of digital communication.

- Features:
- Compact, sophisticated and stylish
  - 1.8" color HD TFT screen
  - Smart digital-analog auto detection
  - Secure communications
  - High-precision GPS positioning module
  - High-efficiency and stable heat dissipation

- Functions:
- Support analog and digital modes and mixed mode
  - Support auto roaming
  - Support individual call, group call and all call
  - Support multiple data services and optional functions
  - Support ARC4 40 bits encryption
  - Support AES and DES Encryption (Optional)
  - Support 5Tone, DTMF, MDC and 2Tone

Frequency Range	136~174MHz,400~470MHz
Channel Capacity	256
Zone Capacity	16
Channel Spacing	25kHz/20kHz/12.5kHz(Analog) 12.5kHz(Digital)
Operating Voltage	13.6V±15%
RF Power Output	10W/25W
Frequency Stability	±0.5 ppm
Dimensions(H·W·D)	151mmx47mmx149mm
Weight	1.15Kg
Digital Vocoder Type	ABME + 2™
Digital Protocol	ETSI-TS102 361-1,-2,-3

# DP770

## DMR Portable Radio

Features:  
 Multiple operation mode  
 Rich voice and data services  
 Compliant to IP67 and US MIL-STD C/D/E/F/G  
 Multiple advanced encryptions  
 Built-in RTC module

Functions:  
 1.8" color TFT screen to display icons, short messages and call  
 TDMA technology for greatly increased capacity of 12.5KHz channel  
 Support digital and analog modes  
 Enhanced security with ARC4, DES and AES encryptions  
 1024 channels, up to 128 channels per zone  
 Support individual/ group/ all call  
 Support emergency call, PTT ID display, emergency alarm, radio check, stun, kill and activation  
 Support lone worker, emergency call, man down  
 Built-in CTCSS/DCS, 2-tone, 5-tone and MDC signalings  
 Support GPS positioning  
 Support VOX  
 Support upgrade to standard digital trunking radio or MPT1327 analog trunking radio  
 Built-in RTC module  
 Support vibration alert for incoming calls



Frequency Range	136~174MHz, 350~400MHz, 400~470MHz
Channel Capacity	1024
Zone Capacity	248
Channel Spacing	25kHz/20kHz/12.5kHz(Analog) , 12.5kHz(Digital)
Battery	2000mAh
Battery Life	Analog:13.5 hours@2000mAh
(5-5-90 Duty Cycle, High TX Power)	Digital: 15.5 hours @2000mAh
LCD	1.77inch, 5 rows
RF Power Output	1W/4W(UHF), 1W/5W(VHF)
Frequency Stability	±0.5 ppm
Dimensions(H·W·D)	137mmx55mmx35mm
(with standard battery, without antenna)	
Weight(with standard battery)	362g(2000mAh)
Digital Vocoder Type	ABME + 2™
Digital Protocol	ETSI-TS102 361-1,-2,-3 ,-4
Dust & Water Protection	IP67 Standard

# DP990/995

## DMR Portable Radio

Features:  
 Multiple operation modes  
 Support Bluetooth and GPS  
 Compliant to IP68 and MIL-STD C/D/E/F/G  
 Multiple advanced encryptions  
 Built-in RTC module

Functions:  
 Support analog and digital modes, compatible with conventional analog systems  
 Messages, calls and more services via programmed Quick Call key  
 Support roaming to achieve automatic channel switching under IPSL repeater system  
 Support pseudo trunking for assignment idle slot group  
 Enhanced security communication with ARC4, DES and AES encryption algorithm  
 Various data services and functions, such as short message, scan, emergency alarm, radio check, monitoring, radio stun/kill/activation and Lone Worker  
 Support individual/ group/ all/ emergency call  
 Support viewing GPS positioning information and sending instant short messages of location information  
 Support upgrade to digital trunking and analog trunking mode



Frequency Range	136~174MH, 400~470MHz
Channel Capacity	1024
Zone Capacity	248
Channel Spacing	25kHz/20kHz/12.5kHz(Analog), 12.5kHz(Digital)
Battery	2000mAh
Battery Life	Analog:13.5 hours@2000mAh
(5-5-90 Duty Cycle, High TX Power)	Digital: 15.5 hours @2000mAh
LCD	1.77inch, 5 rows
RF Power Output	1W/4W(UHF), 1W/5W(VHF)
Frequency Stability	±0.5 ppm
Dimensions(H·W·D)	131.5mmx63.5mmx35.5mm
(with standard battery, without antenna)	
Weight(with standard battery)	385g(2000mAh)
Digital Vocoder Type	ABME + 2™
Digital Protocol	ETSI-TS102 361-1,-2,-3 ,-4
Dust & Water Protection	IP68 Standard



## TM840

### Digital Mobile Radio

Features:

- 1.8" color screen
- Multiple advanced analog signalings
- Compliant to US MIL-STD C/D/E/F/G and IP54
- Support multiple operation modes
- Support upgrade to digital trunking and analog trunking mode
- 5 programmable keys and large-size keypad for convenient operation
- Support Bluetooth(Optional)
- Support Signle frequency repeater mode(Hardware optional)

Functions:

- Support analog and digital modes, compatible with conventional analog systems
- Messages, calls and more services via programmed Quick Call key
- Support roaming to achieve automatic channel switching under IPSL repeater system
- Support pseudo trunking for assignment idle slot group
- Enhanced security communication with ARC4, DES and AES encryption algorithm
- Various data services and functions, such as short message, scan, emergency alarm, radio check, monitoring, radio stun/kill/activation and Lone Worker
- Support individual/ group/ all/ emergency call
- Support viewing GPS positioning information and sending instant short messages of location information
- Support upgrade to digital trunking and analog trunking mode

Frequency Band	136~174MHz, 350-400MHz, 400~470MHz, 450~520MHz
Channel Capacity	1024
Zone Capacity	248
Channel Specing	25kHz/20kHz/12.5kHz(Analog), 12.5kHz(Digital)
Operating Voltage	13.6±15%
LCD	1.77inch, 5rows
RF Power Output	Low Power: 1-25W High Power: 1-40W(UHF)/45W(VHF)
Frequency Stability	±0.5ppm
Weight	1.5Kg
Dimension (W×H×D)	176mm×59mm×183mm
Digital Vocoder Type	ABME+2™
Digital Protocol	ETSI-TS102 361-1, -2, -3, -4
Dust&Water Protection	IP54 Standard

## DR700

### Backpack Repeater

Features :

- Small, light and portable with integrated and compact design
- Intuitive dual keypads for convenient operation
- Built-in large-capacity Li-ion battery with lifetime up to 8 hours
- Built-in high-precision GPS positioning module
- Flexible networking, quick setup, extended communication range and fewer blind zones, better satisfying emergency communication needs
- Support setting up repeater system at single frequency, greatly saving frequency resources

Functions :

- Support digital conventional, analog conventional, single-frequency transfer (digital) and trunking modes
- Support single-frequency repeater mode, setting up a repeater system at a single frequency and greatly saving frequency resources
- Support various data services and optional functions, such as short message, scan, emergency alarm, radio check, remote monitoring, radio stun/kill/activation and Lone Worker
- Support individual call, group call, all call and emergency call
- Advanced encryption and scramble
- Intuitive dual-keypad operation panel with channel display, LED indicators, channel key, and audio interface for external hand microphone, more convenient operation



Frequency Range	350~400MHz, 400~470MHz
Channel Capacity	1024
Zone Capacity	248
Channel Spacing	25kHz/20kHz/12.5kHz(Analog) 12.5kHz(Digital)
Operating Voltage	14.4V±15%
RF Power Output	10W/25W
Frequency Stability	±0.5 ppm
Dimensions(H·W·D)	170mmx243mmx48mm(without battery); 170mmx243mmx75mm(with battery)
Weight	2.2Kg(without battery); 3.2Kg(with battery)
Digital Vocoder Type	ABME+2™
Digital Protocol	ETSI-TS102 361-1, -2, -3, -4



# DR600

DMR Repeater



- Features:
- Compact 1U chassis
  - Intelligent dual-mode operation
  - Enhanced security with data encryption
  - Excellent heat dissipation
  - Convenient management software
  - Extended accessories

- Functions:
- AI S/SI P interface for inter-connection dispatch, telephone system and other facilities to be developed by the third party.
  - Support IP site link connection to extend coverage area
  - Support analog, digital and mixed mode
  - Upgradable to DMR Tier3 mode
  - Analog/digital auto switch, allowing analogue and digital users to work on the same frequency during analog-digital migration
  - Support repeater interconnection via IP port to network two-way radios, achieving distributed data and voice communication in large area
  - Controlled repeater access by radio users, preventing un-authorized access to radio network

Frequency Range	136~174MHz, 350~400MHz, 400~470MHz
Channel Capacity	64
Channel Spacing	25kHz/20kHz/12.5kHz(Analog) 12.5kHz(Digital)
Operating Voltage	DC: 13.6V±15%; AC:100~250V 50/60Hz
Duty Cycle	100%
RF Power Output	High Power: 40W(UHF)/45W(VHF)
Frequency Stability	±0.5 ppm
Dimensions(H·W·D)	485.2mm×450mm×44mm
Weight	10.8Kg
Digital Vocoder Type	ABME+2™
Digital Protocol	ETSI-TS102 361-1,-2,-3,-4

# TR850

DMR Repeater



- Features:
- Dual-mode operation
  - Enhanced security with data encryption
  - Outstanding heat dissipation
  - Convenient management via software
  - Extended accessories
  - Standard 3U rack-mounted cabinet with reserved space for duplexer

- Functions:
- Support monitoring, diagnosis and control both remotely (on the Internet via IP port)
  - Provide interface for AIS/SIP based secondary development, allowing connection to a dispatcher developed by third party
  - Analog/digital auto switch, allowing analogue and digital users to work on the same frequency during analog-digital migration
  - Support repeater interconnection via IP port to network two-way radios, achieving distributed data and voice communication in large area
  - Controlled repeater access by radio users, preventing un-authorized access to radio network

Frequency Range	136-174MHz, 350-400Mhz, 400-470MHz, 450-520MHz
Channel Capacity	64
Channel Spacing	25kHz/20kHz/12.5kHz(Analog), 12.5kHz(Digital)
Operating Voltage	DC: 13.6V±15%, AC:100~250V 50/60Hz
Duty Cycle	100%
LCD	NO
RF Power Output	High Power: 40W(UHF)/45W(VHF)
Frequency Stability	±0.5 ppm
Dimensions(H·W·D)	482.5mm x338.5mm x132.5mm
Weight	11.5Kg
Digital Vocoder Type	ABME+2™
Digital Protocol	ETSI-TS102 361-1,-2,-3,-4

# System Solutions



Kirisun dispatching system solutions can be deployed flexibly and work with commercial or professional digital terminals to achieve communication management as well as remote dispatching and commanding, satisfying diverse communication needs of a wide range of industries and users.

# DS1000 Dispatching System

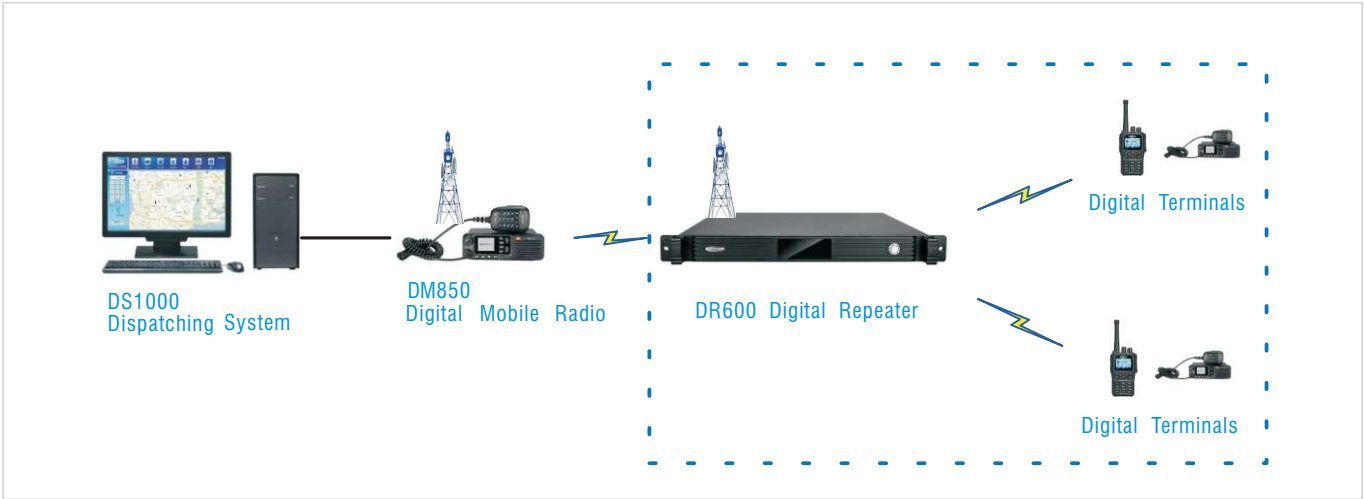

The DS1000 is based on the Kirisun DM850 professional digital mobile radio. It is applicable to Kirisun DMR digital conventional systems, achieving voice dispatching, message dispatching, track playback, record query, background voice recording and remote control through voice and data transmission between digital mobile radios and the dispatching system. The system is suitable for the routine management and dispatching of commercial users such as hotels, estate management and shopping malls.

- Features:
- Simple architecture for easy deployment and use
  - Rich voice services such as individual call, group call and all call
  - Support emergency call and alarm
  - End-to-end AES/DES encryption for secure communication
  - Support advanced signaling based functions such as monitoring, radio check, stun, kill, activation
  - Support background voice recording and real-time call monitoring
  - Support login/logout registration of DMR digital terminals, positioning of GPS based patrol terminals and track playback



# DS6000

## Trunking System

Kirisun's digital trunked radio solution (DMR Tier III) is designed for demanding radio users to deliver business and mission critical communications. Developed in compliance with the ETSI standard, Kirisun DMR trunking offers a customized system based on the individual needs of your organization. Modular and flexible, a Kirisun trunking system can tackle high radio traffic, maximizing available capacity across dynamic user groups and challenging single or multi-site stations.

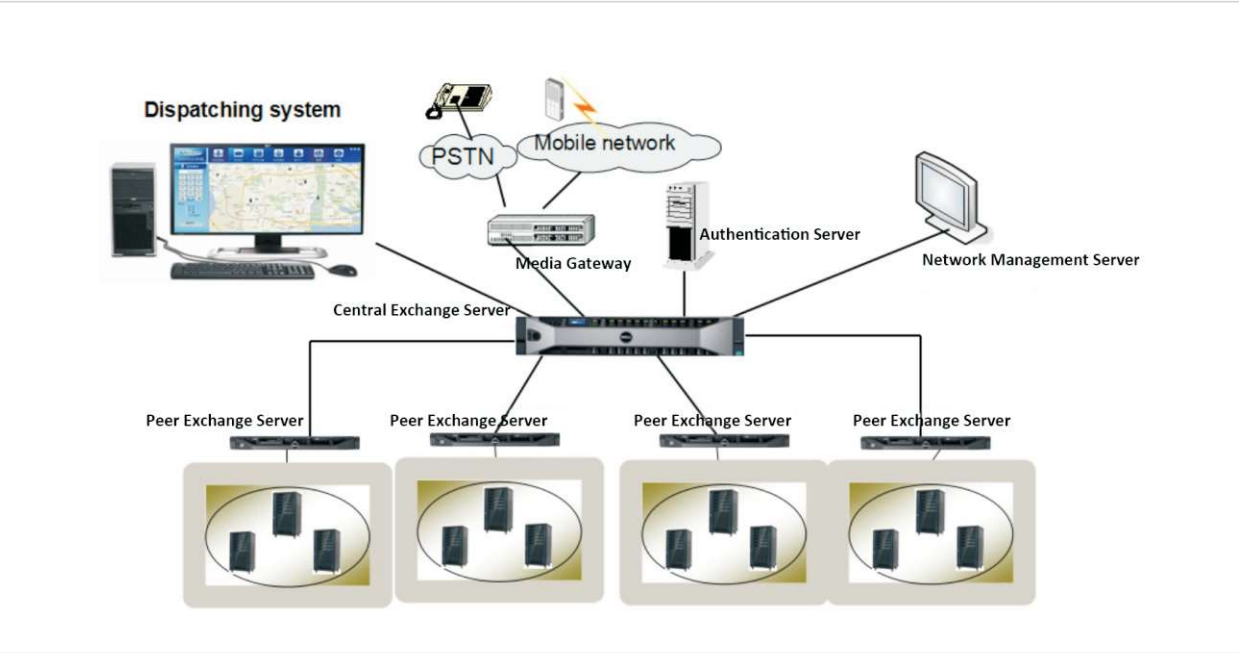

### System Key Features

#### Dynamic Base Station Assignment

It is to dynamically assign a channel to the base station which really needs resources, enhancing the efficiency of channel utilization.

#### Security Functions

End-to-end encryption of voice and data Encryption with 40, 128 or 256 bits with the cryptographic systems AES and ARC4 Support of the DMRA procedure for the encryption transmission via the air interface. Radio stun function.

#### High System Reliability

Kirisun DMR T3 Trunking combines optimal radio coverage with intelligent redundancy design so the availability of the overall system is ensured even if an individual component fails.

- Support multi-level redundant backup of transceivers, channel controller software and switches
- Multi-level fail-soft guaranteeing the utmost communication continuity
- Free of BS controller, active-standby control channel on different transceivers
- Built-in power supply and fans in all transceivers, greatly promoting stability and heat dissipation

#### High Expandability

Different gateways support the interconnection between DMR trunking and other systems, such as SIP PABX, analog conventional, MPT, DMR conventional, etc.

### System Functions

- Authentication
- Emergency Alarm
- Dynamical Group Number Assignment
- Roaming
- Handover
- Priority Call
- Queue
- Registration/ Deregistration
- Individual Cal/ Group Call/ Broadcast Call
- Group Call Late Entry/ Call Merge
- GPS
- Dynamic resource management

### Network Management System

System Topologizing,  
User and group management  
Configuration management  
Status monitor and alarm report.  
BS configuration, management and maintenance.  
Authority management and performance statics  
Logs: Call Logs, Message Logs, Location logs  
OTAP

### Dispatching Console

- Versatile Voice Call&Data Serives  
Various voice calls and textual/status messages between dispatching console and terminal
  - User Management
  - Registration to dispatching console, real-time update of network connection state of terminals
  - Monitoring calls and messages between terminals
  - Kill/ Disable/ Enable/ temporary group
- GIS
- Multiple map modes
  - Point/line-based tracking
  - Time / radio ID based track query and playback
  - Log of group calls, individual calls, messages, kill, disable and data query

### Voice Recording

Recording voice from all terminals identified by caller's ID.

### DMR Trunking Terminals

The trunking terminals include DP990, DP995, DP770, DP970, DP975 and TM840.

Four-mode DMR trunking terminals support analog conventional mode, DMR conventional mode, MPT trunking mode and DMR trunking mode.

Trunking terminals support software upgrade from conventional to trunking mode.

Frequency Range	136-174MHz,350-400MHz,400-470MHz
Carrier Capacity	8
Site Capacity	16
Full Load Power Consumption	2-carrier: ≤600W; 4-carrier:≤1200W
Dimensions	2-carrier:600mm x 600mm x 600mm(9U cabinet); (W×D×H) 4-carrier: 600mm x 600mm x 1200mm (22U cabinet)
Weight	2-carrier: 75kg,2-carrier: 75kg
RF Power Output	High Power: 40W(UHF)/45W(VHF)
Operating Voltage	DC: 13.6V±15%; AC:100~250V 50/60Hz
Frequency Error	±0.5 ppm
Static Sensitivity	0.25@BER5%

# DS5500

## IPSL Digital Dispatching System

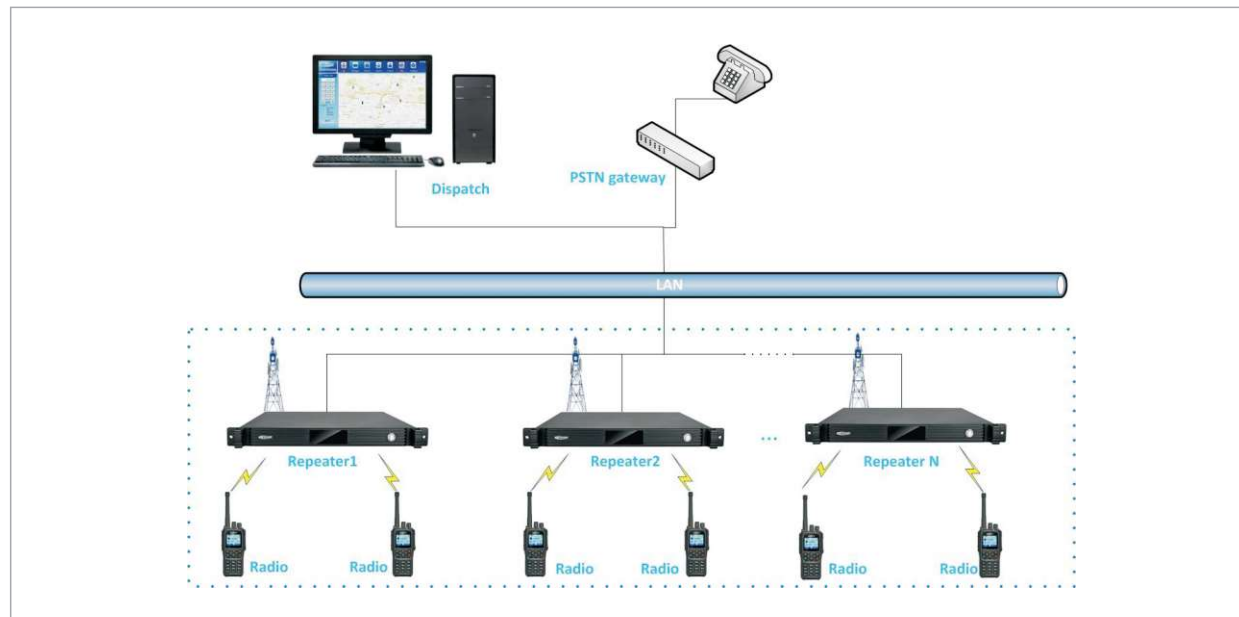

IP network based, the DS5500 connects Kirisun DMR repeater systems in different areas to exchange of voice, data and packages, bringing larger and more efficient network coverage. The system can work with DMR conventional system to achieve interconnection of digital repeaters, voice and message based dispatching, track playback, record query, background voice recording and remote control. Besides, the system can be connected to telephones in the PSTN network using voice gateways. The system is suitable for such fields as judiciary, prisons, forestry, railways, firefighting, ports, security service and large-scale competitions and activities.

### Features:

- Flexible networking of up to 64 DMR repeaters to achieve large network capacity
- Support communication within individual regions and across the network
- Rich voice services such as individual call, group call, all call and emergency call
- Support emergency alarm
- Support remote monitoring and diagnosis
- End-to-end encryption (AES/DES)
- Visual dispatching system (optional),
- PSTN telephony (optional)
- Advanced signaling based functions such as remote monitoring, radio check, stun, kill, activation and call removal
- Background voice recording and real-time call monitoring
- Support login/logout registration of DMR digital terminals, GPS guard tour and tracking playback

## PoC Solution



PoC is a service that provides push to talk communications via cellular network or WIFI network. User can make call without coverage issue.

Kirisun provides end to end PoC solution including portable radio, mobile radio, PoC platform and dispatch system.

### Application Scene:

Security, Logistics, Taxi, Retail, Hotel, Oil



# PoC Solution Network

PoC Solution Network architecture consists of three layers, the top layer is management layer, the intermediate layer is network layer, the bottom layer is terminal layer.the management layer include the network management system, the dispatcher and the software switch server. These three parts were deployed in the public Cloud. The network layer is the Telecom Operator network. The terminal layer include W60/65, T60/65, M50(3G),M50(4G) and the Press2Talk App.

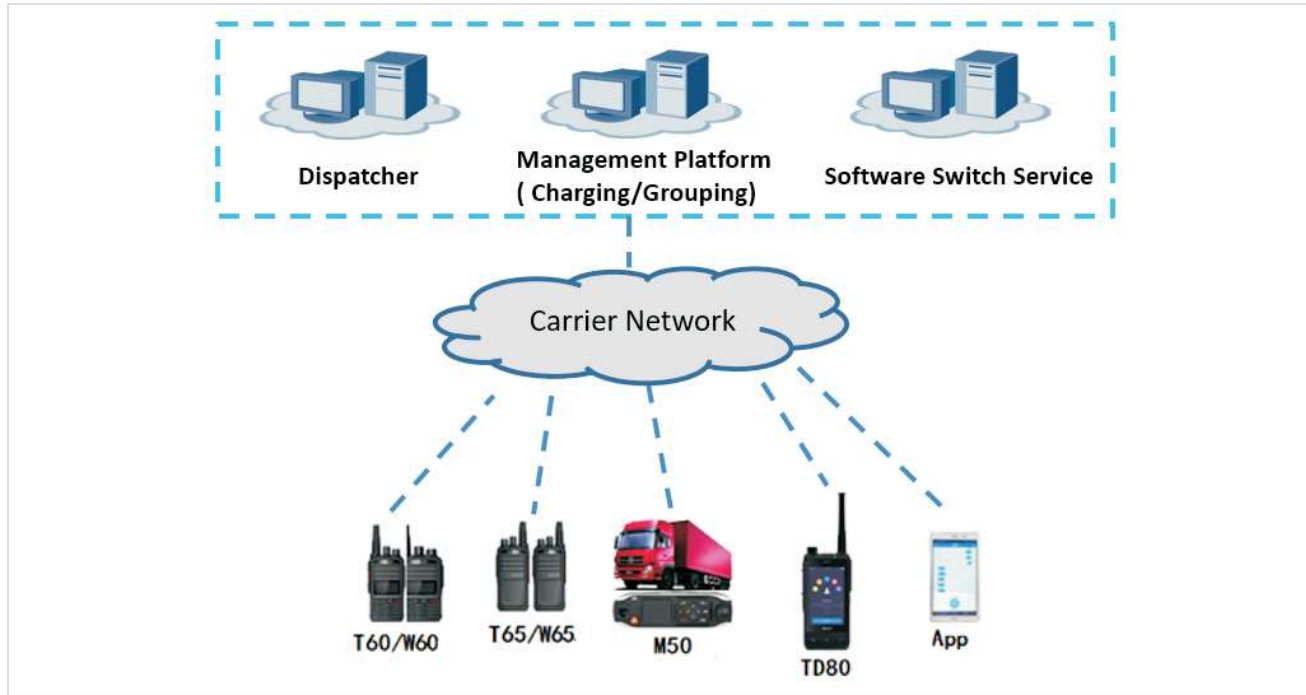

PoC Network Management System

Billing

Terminal

Terminal List

Online Time

Parameter Setting

Data Usage

Group

Client

Account

Welcome to use PoC Network Management System

郑培辉Help CenterDispatcherExit

Home PageTerminal ListParameter Setting

RefreshClose

Terminal ID:Terminal Name:Client Name:演示总群

TerminalDispatcher

ClearOpen +

Channel ConfigurationModify Terminal Configuration

	Terminal ID	Terminal Name	Show Menu	Show Bluetooth In Menu	Show WIFI In Menu	Show GPS In Menu	Bluetooth State	WIFI State
1	M3030113720	M50	Default	Default	Default	Default	Default	Default
2	M2030301550	1550	Default	Default	Default	Default	Default	Default
3	M1111111111	T1111	Default	Default	Default	Default	Default	Default
4	M1030201040	1550	Default	Default	Default	Default	Default	Default
5	M0023750589	T1111	Default	Default	Default	Default	Default	Default
6	M0023750589	1550	Default	Default	Default	Default	Default	Default
7	M0023151146	T1111	Default	Default	Default	Default	Default	Default
8	C6500010068	C65	Default	Default	Default	Default	Default	Default
9	C6500010057	C65	Default	Default	Default	Default	Default	Default
10	C6000010977	C60						

# PoC Dispatching Console

The PoC dispatcher console support voice dispatching, short message, voice recording and log history.

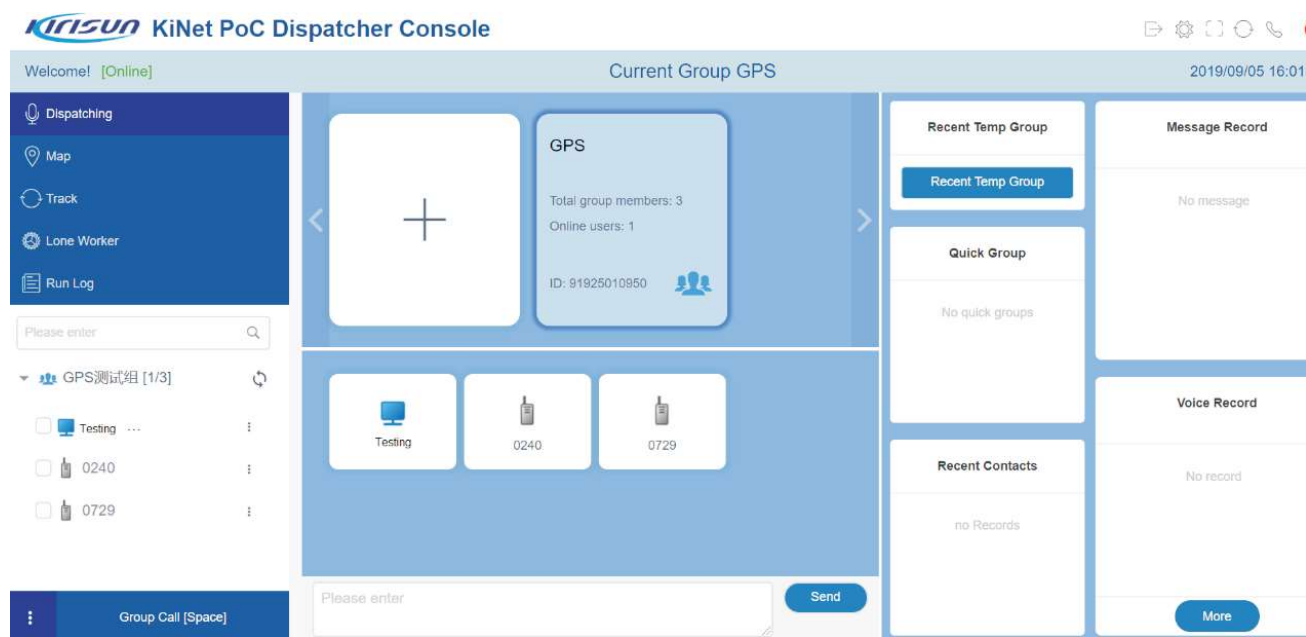

- Main Functions:
- Support individual call, group call and temporary group call
  - Support GPS tracking and Geo-Fencing
  - Support voice recording and playback
  - Support electronic patrol management
  - Support log query and log export

# W60/65

## 3G Portable PoC Radio

PoC is a service that provides push to talk communications via cellular network or WIFI network. User can make call without coverage issue. W60/W65 is 3G PoC radio with traditional walkie-talkie model.

### Main Functions:

- ★ Wide coverage with carrier network
- ★ LED Display
- ★ Build-in WIFI
- ★ Build-in Bluetooth
- ★ GPS positioning
- ★ Software upgrade via OTA
- ★ Support voice services (all call, group call, individual call), text message, tone alert
- ★ Support radio kill, radio stun, radio revive and radio monitor
- ★ Support real-time contacts status
- ★ Support voice recording



Frequency Band	WCDMA,GSM
Battery	3600mAh / 5200mAh(Optional)
Operating Temperature	-20℃~+50℃
Storage Temperature	-40℃~+85℃
Dimension (W×H×D)	115mm*54mm*30mm
Display	160*128 pixels,monochrome LCD screen
Weight	330g
Dustproof & Waterproof	IP54

# T60/65

## 4G Protatable PoC Radio

PoC is a service that provides push to talk communications via cellular network or WIFI network. User can make call without coverage issue. T60/T65 is 4G PoC radio with traditional walkie-talkie model.

### Main Function:

- ★ Widecoverage with carrier network
- ★ LED Display
- ★ Build-in WIFI
- ★ Build-in Bluetooth
- ★ GPS positioning
- ★ Software upgrade via OTA
- ★ Support voice services (all call, group call, individual call), text message, tone alert
- ★ Support radio kill, radio stun, radio revive and radio monitor
- ★ Support real-time contacts status
- ★ Support voice recording



Frequency Band	4G LTE,WCDMA,GSM
Battery	3600mAh/5200mAh(optional)
Operating Temperature	-20℃~+50℃
Storage Temperature	-40℃~+85℃
Dimension (W×H×D)	115mm*54mm*30mm
Display	160*128 pixels,monochrome LCD screen
Weight	330g
Dustproof & Waterproof	IP54



# M50 3G

## PoC Mobile Radio



M50 mobile radio support PoC service via 3G network without coverage limitation. It is easy to install and deploy in the vehicle.

Application Scene:

Logistics, Construction, Transportation, Taxi

Main Function:

- ★ Wide coverage with carrier network
- ★ LED Display
- ★ Build-in WIFI
- ★ Build-in Bluetooth
- ★ GPS positioning
- ★ Software upgrade via OTA
- ★ Support voice services (all call, group call, individual call), text message, tone alert
- ★ Support radio kill, radio stun, radio revive and radio monitor
- ★ Support real-time contacts status
- ★ Support voice recording

Network and Frequency Band	WCDMA,GSM
Operating Temperature	-20℃ ~ + 50℃
Storage Temperature	-40℃ ~ + 80℃
Dimension (W×H×D)	153mm*44mm *51mm
Display	160*128P pixels,monochrome LCD screen
Weight	280g
Dustproof & Waterproof	IP54

# M50 4G

## PoC Mobile Radio



M50 mobile radio support PoC service via 4G/3G network without coverage limitation. It is easy to install and deploy in the vehicle.

Application Scene:

Logistics, Construction, Transportation, Taxi

Main Functions:

- ★ Wide coverage with carrier network
- ★ LED Display
- ★ Build-in WIFI
- ★ Build-in Bluetooth
- ★ GPS positioning
- ★ Software upgrade via OTA
- ★ Support voice services (all call, group call, individual call), text message, tone alert
- ★ Support radio kill, radio stun, radio revive and radio monitor
- ★ Support real-time contacts status
- ★ Support voice recording

Network and Frequency Band	4G LTE,WCDMA,GSM
Operating Temperature	-20℃ ~ + 50℃
Storage Temperature	-40℃ ~ + 80℃
Dimension (W×H×D)	153mm*44mm *51mm
Display	160*128pixels, monochrome LCD screen
Weight	280g
Dustproof & Waterproof	IP54

# PoC App

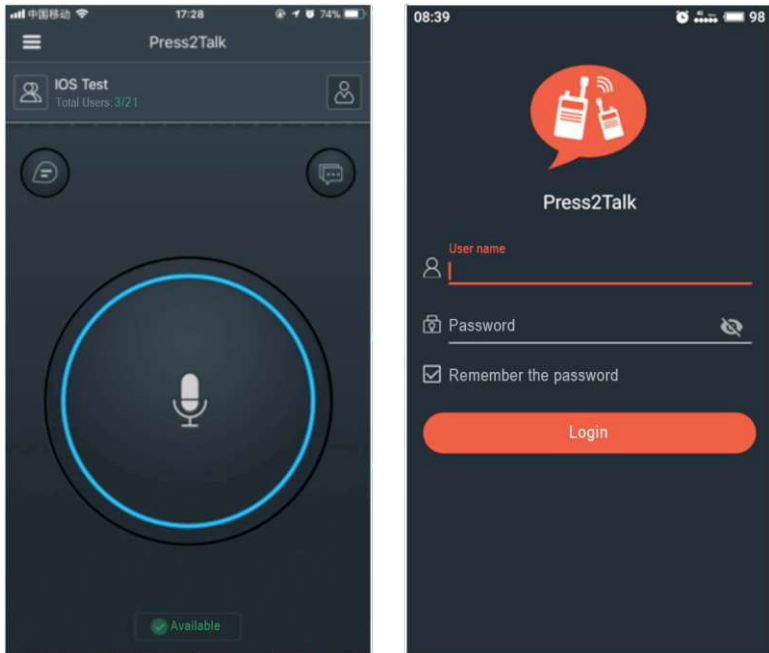

The mobile application Press2Talk App achieves rapid, low-flow and high-efficiency PTT service. It is capable of individual call, group call, temporary group call, short message, achieving real-time dispatching more efficiently via mobile terminal.

- Features:
- Global PoC service
  - HD voice and map-aided positioning
  - Support multiple vocoders, HD voice, individual call, group call and call interruption
  - Support textual and multimedia messages
  - Support precise map-aided positioning, uploading position information and viewing group members' position information
  - Support PTT with a dispatcher, PoC two-way radio and mobile radio
  - Support Bluetooth earphone and Bluetooth hand microphone
  - Support IOS 9.0+ and Android 4.4+

# TM840-GW

PoC DMR Interconnection  
Mobile Radio



TM840-GW support voice interconnection between DMR radio and PoC radio.

- Main Function:
- ★ Wide coverage with 4G/3G carrier network
  - ★ LED Display
  - ★ Build-in WIFI
  - ★ Build-in Bluetooth
  - ★ GPS positioning
  - ★ Software upgrade via OTA
  - ★ Support voice services (all call, group call, individual call),text message, tone alert
  - ★ Support radio kill, radio stun, radio revive and radio monitor
  - ★ Support DMR tier2 tier3 radio



PoC Frequency Band	4G LTE,WCDMA,GSM
DMR Frequency Band	136MHz-174MHz 350MHz-400MHz 400MHz-470MHz
Operating Temperature	-20℃ + 55℃
Storage Temperature	-40℃ + 80℃
Dimension(H*W*D)	165mm*260mm*220mm
Display	1.8 inch
Weight	<6000g
Dustproof & Waterproof	IP54



# Body Worn Cameras



Kirisun is the main body worn camera solution provider on the market. Using artificial intelligence to create situational awareness, the assistive features operate seamlessly within our complete evidence ecosystem. Finally, a smart solution for law enforcement.

# DSJ-H9s

H9S body worn camera is elegant and generous and the original rotatable camera design meets the needs of more shooting angles. At the same time, it adopts high-definition high-brightness capacitive touch screen design, which is convenient and comfortable to operate.

- Main Features:
- ★ Rotating camera to meet the different scenes
  - ★ Pogo Pin interface charging
  - ★ One button recording function
  - ★ Important video remark function
  - ★ Secure recording format with built-in encryption and watermarking
  - ★ Automatic continuous shooting function
  - ★ Removable battery design, support long term continuous recording
  - ★ Built-in LED white light fill function
  - ★ Built-in laser positioning function
  - ★ File hierarchical management and password authorization to ensure data security



Dimension	100mm*62mm*23mm
Weight	156g
Dust/Water Ingress Protecton	IP67
LCD Display	2.4-inch LCD
Field of View	JPEG
Photo Format	2304*1296, 1920*1080, 1280*720, 848*480
Video Resolution	Mov/Mp3
Format	2500mAh
Battery	5m
IR Night Vision	32G(64G,128G optional)
Drop test	2m
Operating Environment	-20℃-55℃
Charging	Mini USB

# DSJ-F9s

DSJ-F9S body worn camera is finely designed with thoughtful details such as ergonomic 360-degree rotary belt clip that is easy to wear, keys with super touch, anti-skid shell and drop resistance.

- Main Features:
- ★ Compact & Reliable design
  - ★ Long battery life
  - ★ Pogo Pin interface charging
  - ★ One button recording function
  - ★ Important video remark function
  - ★ Secure recording format with built-in encryption and watermarking
  - ★ Automatic continuous shooting function



Dimension	82*56*31mm
Weight	134g
Dust/Water Ingress Protection	IP67
LCD Display	2.0-inch LCD
Field of View	Horizontal 125°
Photo Format	JPEG
Video Resolution	2304*1296 , 1920*1080 , 1280*720 , 848*480
Format	MP4/WAV
Battery	5m
IR Night Vision	32G (64G,128G optional)
Drop test	3.5m
Operating Environment	-20℃~55℃
Charging	Mini USB

# DSJ-M9

## 4G Body Worn Camera

DSJ-M9 is based on the Android platform and support 4G LTE network. The product is elegant and generous and the original rotatable camera design meets the needs of more shooting angles. At the same time, it adopts high-definition high-brightness capacitive touch screen design, which is convenient and comfortable to operate.

- Main Features:
- ★ Larger speaker cavity for clear and loud voice
  - ★ GPS and NFC function
  - ★ One button recording function
  - ★ Important video remark function
  - ★ Secure recording format with built-in encryption and watermarking
  - ★ Automatic continuous shooting function
  - ★ Non-removable battery design, support long term continuous recording
  - ★ File hierarchical management and password authorization to ensure data security
  - ★ Real-time video transmission and dispatch system via 4G network
  - ★ PoC function



Dimension	120mm*66mm*28mm
Dust/Water Ingress Protection	IP67
LCD Display	3.5 -inch LCD
Field of View	Horizontal 125°
Photo Format	JPEG
Video Resolution	2304x1296,1920*1080 , 1280*720
Format	MP4/WAV
Battery	5000mAh
IR Night Vision	5m
Storage	32G(64G,128G optional)
Drop test	2m
Operating Environment	-20℃~55℃
Charging	Mini USB, Pogo pin

# DSJ-K9

## 4G Body Worn Camera

DSJ-K9 is based on the Android platform and support 4G LTE network. The product is elegant and generous and the original rotatable camera design meets the needs of more shooting angles. At the same time, it adopts high-definition high-brightness capacitive touch screen design, which is

- Main Features:
- ★ Larger speaker cavity for clear and loud voice
  - ★ GPS and NFC function
  - ★ One button recording function
  - ★ Important video remark function
  - ★ Secure recording format with built-in encryption and watermarking
  - ★ Automatic continuous shooting function
  - ★ Non-removable battery design, support long term continuous recording
  - ★ File hierarchical management and password authorization to ensure data security
  - ★ Real-time video transmission and dispatch system via 4G network
  - ★ PoC function



Dimension	116mm*64mm*25mm
Dust/Water Ingress Protection	IP67
LCD Display	3.1- inch LCD
Field of View	Horizontal 125°
Photo Format	JPEG
Video Resolution	2304×1296, 1920×1080, 1280×720
Format	MP4/WAV
Battery	3500mAh
IR Night Vision	5m
Storage	32G(64G,128G optional)
Drop test	2m
Operating Environment	-20℃-55℃
Charging	Mini USB,Pogo pin

# Docking Station

The body worn camera docking station provides an all-in-one video evidence management solution.

- ★ Providing data management and storage server
- ★ Auto data transferring when body worn camera is connected
- ★ Securely manage all videos, photos and audio files
- ★ Continuing with data transferring after interruption
- ★ Support multiple body worn cameras charging and data transferring
- ★ Search and playback evidence with different criteria
- ★ Assigning body worn camera to one user or multi-users



Dimension	400*300*120mm
CPU	Intel CPU 2.8GHZ
Memory	4GB(Max 32GB)
Motherboard	Industry level
Storage	Monitor class, 4TB, expandable
Screen	10 inch
Power	150W server power 1A per USB port
Port Number	8
Function	CPU temperature monitoring, system temperature monitoring, CPU fan speed monitoring



# Kirisun KiNet Intelligent Network System



Smart Multi-Network Interconnection Solution  
Connect Your Multi-Network Together

# All in one : Kirisun Intelligent Network

Based on advanced wireless and cloud computing technology. Realize the interconnection between DMR Tier2 system, DMR Tier3 system, POC system, Body worn camera system and 3rd party IP camera.

Service  
Convergence

Open  
Platform

Supports SIP protocol, which is a standard international standard, and provides SDK for third-party equipment accessing.

KiNet

The system adopts high reliable hardware platform and Linux operating system, supports dual hot standby, and has rich system log function.

High  
Reliability

Flexible  
Deployment

Lightweight and easy to deploy, save Capex & Opex . Easy integration of modules, meet the requirements of different industry.

## KiNet System Overall Architecture



# Solution Highlights

All voice convergence : DMR + Analog + PoC + PSTN/PABX

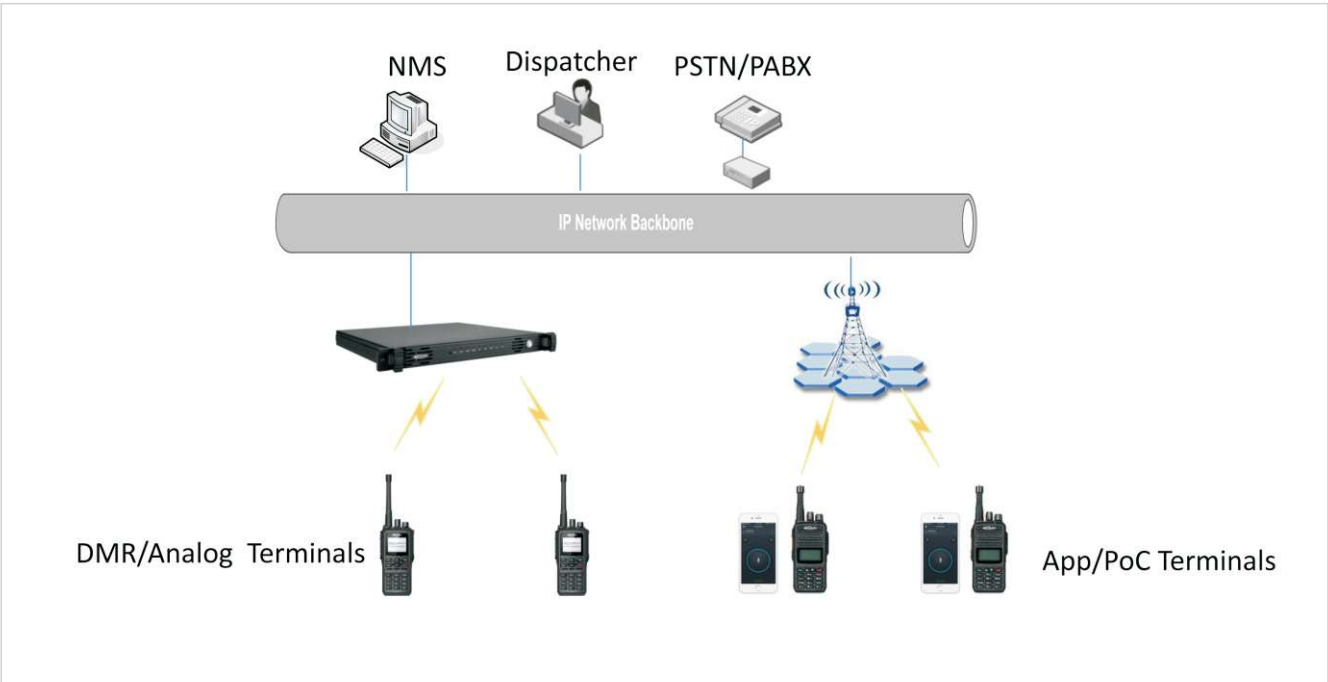

Multi-network convergence, Unified platform, Unified dispatching

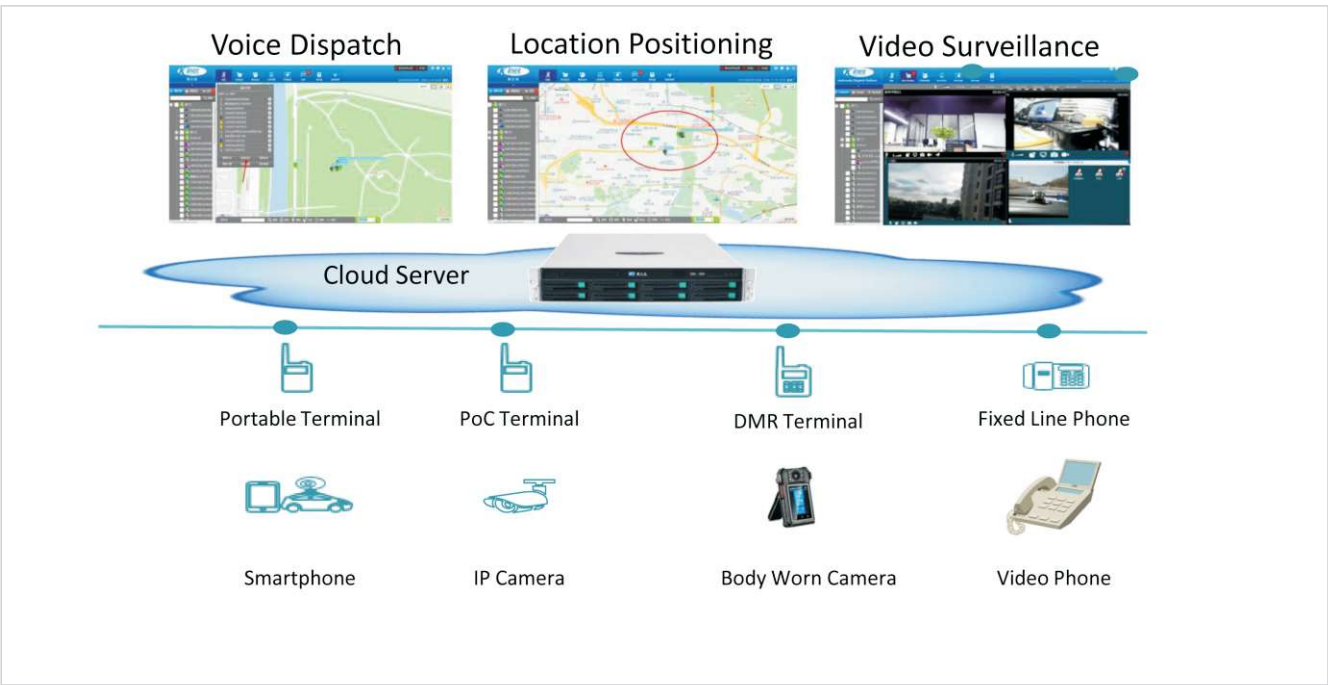

# Feature Summary:

